



# Line Items

The Official  
Newsletter  
Of Excelsior EMC

January 2025 • Vol. 45, No. 11

## MINI-SPLITS AT A GLANCE

Mini-split systems, also known as ductless air-source heat pumps, heat/cool a home through an outdoor unit that connects to one or more individual indoor air handlers, which are typically mounted on a wall. Depending on the size of your home and personal preferences, a mini-split system is worth considering when you need to replace or upgrade your heating/cooling system.

### Mini-Split System Benefits:

- Zone-controlled heating/cooling
- Higher energy efficiency ratings
- Easy to install
- Good for heating/cooling home additions

### Mini-Split System Considerations:

- Potentially higher upfront cost
- Appearance
- May require electrical upgrades
- Not as effective in large spaces



Imagine being able to set the perfect temperature for each room in your home. Mini-split systems, also called ductless heat pumps, make this possible while being energy-efficient and easy to use.

A mini-split system heats and cools specific rooms or areas in your home. It includes two main parts: an outdoor unit and one or more indoor units, connected by a small pipe. Unlike central systems that rely on long ducts, mini-splits don't use ducts, which means less energy is wasted. Each indoor unit allows you to control the temperature in one area without affecting the rest of the house, saving energy and money.

Mini-splits are great for home additions, basements, attics, or any space far from the main heating and cooling system. Installation is simple, needing only a small hole for the connecting pipe. One outdoor unit can support up to four indoor units, each with its own thermostat for personalized comfort.

These systems have other perks too. They're quiet, improve air quality, and are easy to install. Many come with remote controls, and their compact design offers flexible placement options. Mini-splits are also very efficient, with higher energy ratings than traditional systems.

However, there are a few things to consider. Mini-splits cost more upfront—\$1,500 to \$2,000 per ton of cooling capacity, which is about 30% more than central systems (without ducts) and twice as much as window units. If you live in a very cold climate, you might need a backup heating source. Also, some people don't like the look of the indoor units, which are more visible than traditional vents.

If you're thinking about upgrading your home's heating and cooling, talk to an expert to see if a mini-split system is a good fit for you.

# Line Items

Joseph Jones  
Editor

## BOARD OF DIRECTORS

Mike Anderson <i>Chairman</i>	Statesboro, Georgia
Wade Hodges <i>Vice Chairman</i>	Statesboro, Georgia
G.W. Johnson <i>Secretary-Treasurer</i>	Twin City, Georgia
Jordy Carter	Metter, Georgia
David Cromley	Brooklet, Georgia
Amy Hendrix	Metter, Georgia
Russell Mathis	Statesboro, Georgia
Grady McCray	Metter, Georgia
Solly Trapnell	Statesboro, Georgia

Greg Proctor  
*President/CEO*

Bill Walden  
*Executive Vice President*

Howard Porter  
*Vice President, Engineering Services*

Lindy Chester  
*Vice President, Finance and Member Services*

Bronson Bragdon  
*Director of Marketing and Communications*

Josh Holland  
*Director of Operations*

*This institution is an equal opportunity  
provider and employer.*

**When Your Power is Off - Call  
(912) 685-2115 or (912) 764-2123**

When your power goes off, don't stay in the dark longer than you have to. To restore your power as quickly as possible, we need your correct phone number. Your phone number is the quickest way for us to locate your home or business when you call to report an outage.

LINE ITEMS (ISSN 1089-9987) is published monthly for \$1.00 per year by Excelsior EMC, 2574 Northside Dr West, Statesboro, GA 30458. Periodicals postage paid at Statesboro, Georgia. POSTMASTER: Send address changes to LINE ITEMS, P.O. Box 297, Metter, Georgia 30439

## Between the Lines

by  
Greg Proctor  
President/CEO

### *Making Plans for the New Year*

You're probably familiar with General Beauregard Lee, the celebrated groundhog from Georgia who predicts if winter will stick around or spring will come early.

General Beauregard Lee has gained fame for his Southern charm and his weather-predicting prowess. Unlike some of his northern counterparts, Beau is known for a higher accuracy rate—some say he's right nearly 90% of the time! On February 2, all eyes turn to his cozy home at Dauset Trails in Jackson, Georgia, to see whether Beau will see his shadow. Whether he predicts more winter or an early spring, one thing is for certain: he brings joy and excitement to Groundhog Day celebrations.

No matter what General Beauregard Lee forecasts, the start of a new year is always a good time to explore ways to simplify your life.

For instance, have you thought about whether your current bill payment method fits your needs? Excelsior EMC offers several payment options tailored to your preferences. Do you want to pay the same amount each month? Check out our levelized billing program, which averages your payments for better predictability. Want more control over when you pay for your electricity? Try our Pay-Your-Way pre-pay program, allowing you to pay as you go instead of receiving a monthly bill. Or maybe you'd prefer to set it and forget it with our draft option, which automatically charges your bank account the monthly bill amount.

The new year is also a great time to explore other options. Are you curious about electric vehicles or solar power? Not-for-profit co-ops like Excelsior EMC are excellent resources for learning more about these energy innovations. Visit our website at [www.excelsioremc.com](http://www.excelsioremc.com) to explore our solar and EV tools or call us at 912-685-2115 with any questions.

We're here to help you make wise energy choices. Remember, the folks at your local electric cooperative are your "Hometown Energy Experts" every day of the year.



Every Member Counts

# Envelope Advances

Improving a building's efficiency can usually be accomplished with simple methods like caulking, sealants and insulation. But the movement toward ultra-efficient homes and businesses has brought amazing innovations to the building envelope—walls, windows, roof and foundation—that minimize the energy it takes to keep the inside space conditioned and comfortable. Here are some of the latest advances in this growing field.

## Cooling roof material

Highly reflective granules reduce solar heat entering the building

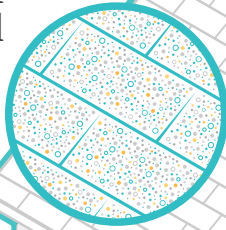

## Metal roofing

Effective at reflecting heat away from the building



## Radiant barrier

Foil-lined foam insulation board covering interior side of the roof

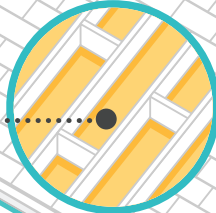

Conditioned attic space

## Attic insulation

High-R fiberglass batting reduces heat/cold loss



## Aerogels

Thin, porous material; flexible and extremely efficient insulator

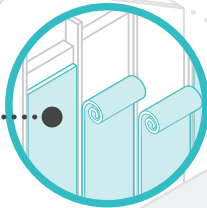

## Vacuum insulation panels

Thin, porous sheet wrapped in aluminum to reduce heat transfer

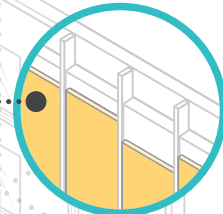

## High-performance window frames

Vinyl or fiberglass frames with multiple insulation-filled cavities

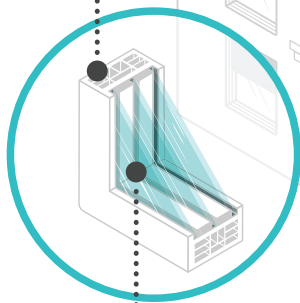

## Automated window shades

Exterior or internal blinds that adjust automatically to block sunlight in summer and admit it in winter



## Insulated glass door

Durable fiberglass door with foam insulation and treated, multiple-paned window



## Highly insulated glass

Multiple panes with transparent, insulative inserts like aerogels or inert gas



Conditioned living space

## Reflective glass

Low-emissivity coatings to control heat transfer



# PROJECT SHARE:

*Neighbors Helping Neighbors*

For several years Excelsior EMC consumers have had the opportunity to help needy people in our community by contributing to the Salvation Army program known as Project SHARE. Excelsior EMC is one of the many utilities involved in helping citizens who need assistance with basic necessities such as housing, food, medical care, and utility services. Project SHARE helps the elderly, disabled, and those afflicted with illness, and others who are experiencing serious financial hardships.

An attractive part of the program is that your contribution goes to help someone from the county where the donation originated. Locally,

the Department of Family and Children Services handles Project SHARE funds.

If you would like to participate, check the appropriate space and complete the form located on this page and return with your next payment.

This amount will be added each month to your bill. Anyone wishing to make a larger contribution should mail it directly to:

**The Salvation Army**  
Project SHARE  
P.O. Box 930188  
Norcross, GA 30003-0188

## Yes, I'd like to participate in Project SHARE.

<b>Please add:</b>	Name _____
<input type="checkbox"/> \$1	Address _____
<input type="checkbox"/> \$2	City _____ State _____ Zip _____
<input type="checkbox"/> \$5	Account Number (we bill) _____
to my electric account each month.	Signature _____

PERIODICALS POSTAGE  
PAID AT  
STATESBORO, GA 30458